

DIN 98

Revolving handles

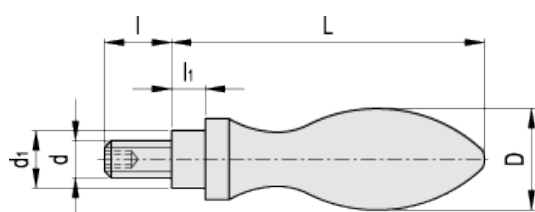

Code	Description	Main dimensions				Threaded shank		Weight
		D	L	$d_{1\ h13}$	l_1	d	l	g
CN.11105	DIN 98-ST-16-E	16	54.5	10	5.5	M6	11	55
CN.11125	DIN 98-ST-20-E	20	67	13	6	M8	13	104
CN.11145	DIN 98-ST-25-E	25	83	16	8	M10	14	187
CN.11165	DIN 98-ST-32-E	32	105.5	20	10.5	M12	21	387
CN.11175	DIN 98-ST-36-E	36	117	22	11	M16	26	541

Material

Turned and zinc-plated steel.

Standard execution

Zinc-plated steel shank, hexagon socket at threaded end.

Special executions on request

h8 plain pin (DIN 98-D).